



HERDS

January - March 2016 Edition

The Newsletter of the Museum of the Red River in Idabel, Oklahoma

Construction Begins!



Mary H. Herron Community Conference Center now hosts exhibits, programs, and the Museum Store



Conference Center Hallway



Museum Store in the *OM* Seminar Room

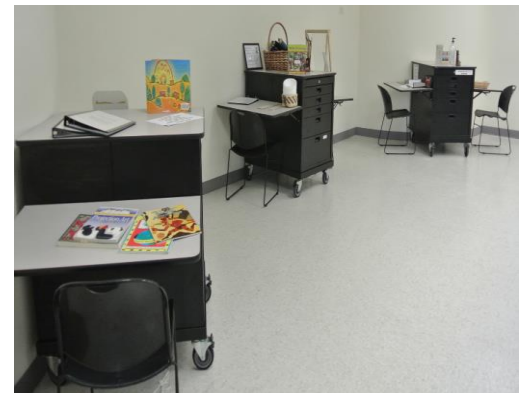

Learning Kiosks in *Los Pinos* Classroom

The Museum's exhibits and programs have officially moved to the Mary H. Herron Community Conference Center. Activities from the Holland and Sallie Webb Family Learning Center are now housed in the *Los Pinos* Classroom. The Store, now in the *OM* seminar room, continues to offer a lot of beautiful and unique merchandise.

The museum staff have created a stunning display area in the M.J. "Jack" Bell Hall for the Seven-State Biennial Exhibition, for Recent Acquisitions, and for selections from the permanent collections. While there have been many changes, it has been a surprisingly smooth transition and now it's time for the renovations to begin!

Museum Store



DIRECTIONS



Henry Moy, Director

a busy year (2015) of celebrating our 40th anniversary, the Museum “slows down” by commencing upon its next construction project. Prepared to spend 4+ million dollars over the next 18 months, we will address issues that affect our ability to meet our core mission. A collecting institution, the Museum is creating additional, climate-controlled storage facilities in anticipation of acquiring many thousands of artifacts and related materials in the near future. An exhibiting institution, we are adding to our galleries, making more of our collections (30,000+ objects) visible. An “informal” educational institution, we are creating larger and better-equipped spaces for programs and interactive activities. In order to accommodate these improvements and maintain our public services, we will have to suffer some inconveniences. Programs and exhibits are taking place in the Mary H. Herron Community Conference Center. The Museum Store has also been relocated there. Office spaces are in transition so various staff may be hard to get a hold of at times. We apologize for the inconveniences and hope that when all is said and done, our visitors will enjoy the new, and newly renovated, spaces.

To keep up with the project, follow our Facebook page (with twice-a-week updates) and our website www.museumoftheredriver.org (for more photographs of our progress).

PROGRAMS & EVENTS (January – April 2016)

Thursday, Jan 1

Museum CLOSED (Reopens Jan 2)

Wednesday, Jan 27

Program: Paleo Pals for student ages 4-8 for 3:30 – 4:30: *What is Paleontology?*

Through Sunday, Jan 31

Exhibit Closes: *Seven-State Biennial Exhibition* (M.J. “Jack” Bell Hall)

Tuesday, Feb 9

Exhibit Opens: *Contemporary American Ceramics* (through Jun 19)

Wednesday, Feb 24

Program: Paleo Club for student ages 9-12: *What is Paleontology?*

Saturday, Mar 5

Program: *11th Annual Mary H. Herron Memorial Kite Flight*

Sunday, Mar 6

Exhibit Closes: *Recent Acquisitions: The Florence Marie Rondell LaGrande Free Collection*

Tuesday, Mar 15

Exhibit Opens: *OsteoDontoKeratic: The “Stuff” of Tools and Treasures* (through Jun 19)

Tuesday, Mar 15

Gem and Mineral Club Meeting, 7:00 pm

Wednesday, Mar 30

Program: Paleo League for students ages 13-16: *What is Paleontology?*

Saturday, Apr 2

Program: *11th Annual Acro Fest* at Dogwood Days, downtown Idabel

Friday, Apr 22

Museum Annual Dinner with Ken Carpenter



Vases, late 19th/early 20th century
Chinese
Gift of Wally Mason

Herron Foundation

Board of Directors

Tina Foshee-Thomas, *Mayor of Idabel*

William C. Gentry, *Esq.*

Donald Herron, *President*

Janet Herron, *Secretary*

Richard Q. Herron

John Ramsey

Terry Walker

Sallie Webb

Henry Moy, *Executive Secretary*

Lavetta Ward, *Treasurer*

Idabel Museum Society

Board of Directors

Dr. Robert Brooks

Dr. Bruce King, *Vice President*

Carolynn Neal

Judy Petre, *President*

John Ramsey

Dr. Lewis Stiles, *Treasurer*

Terry Walker

Museum of the Red River

Staff

Jeanette Bohanan, *Head of Communications*

Christina Eastep, *Head of Programs*

Terrance King, *Custodian*

John Malin, *Museum Assistant*

Sherron Mitchell, *Gift Shop Mgr.*

Henry Moy, *The Quintus H. Herron Museum Director*

Vickie Smith, *Business Manager*

Daniel Vick, *The Mary H. Herron Keeper of Collections*

EXHIBITS 2016

The Museum's main galleries *will be CLOSED* during 2016 for renovation. Exhibits will be mounted in the *M.J. "Jack" Bell Hall* and *Nathaniel and Lana Grey Gallery* of the Mary H. Herron Community Conference Center.

Mary Bratton Curtis Gallery (CLOSED through 2016)
Perino Archaeological Study Area (CLOSED through 2016)
Lifeways Gallery (CLOSED through 2016)

M.J. "Jack" Bell Hall

(Mary H. Herron Community Conference Center)

Seven-State Biennial Exhibition (December 8 - January 31, 2016)

A juried biennial exhibition of works from artists living in Oklahoma and the six states bordering it. This year's judge is noted Colorado sculptor **James Surls**. The Museum of the Red River begins its sponsoring partnership with the University of Science and Arts of Oklahoma (Chickasha) and the Charles B. Goddard Center (Ardmore) with this exhibit.



Ladies in Waiting (1st Place)
Colleen McCulla-Thomas
fabric and plaster

Contemporary American Ceramics (February 9 - June 19)

An exhibit of loaned works including ceramic vessels and forms created by some of the most celebrated artists working today.

Birds In Art (June 28 - August 14)

An exhibit of works from artists around the world, drawn from the 2015 annual juried exhibit of the Leigh Yawkey Woodson Art Museum (Wausau, WI).

Nathaniel and Lana Grey Gallery

(Mary H. Herron Community Conference Center)

The Florence Marie Rondell LaGrande Free Collection (Oct 20, 2015 - March 6, 2016)

OsteoDontoKeratic: The "Stuff" of Tools and Treasures (March 15 - June 19)

Japanese Ceramics (June 28 - Sept 11)

Recent Acquisitions (Sept 20 - Jan 8, 2017)



Seven-State Biennial Exhibition installed in the *M.J. "Jack" Bell Hall* of the *Mary H. Herron Community Conference Center*



Horse Tails (2nd Place)
George Oswalt
oil



Reincarnation (3rd Place)
Mary Forbes
embroidery thread on canvas



Nathaniel and Lana Grey Gallery

RECENT ACQUISITIONS

Gifts to the Collections (October - December, 2015)

Gold alloy nose **ornament** (Peru, Chavin/Salinar period, ca. 1200 - 600 BC)
Gift of **Dr. Adam Wiraszka** (Corpus Christi, TX)



Gold Alloy Nose Ornament ca. 1200-600 BC
Peru, Chavin/Salinar
Gift of **Dr. Adam Wiraszka**

Group of twenty-five (25) **baskets** from native American groups in the Southeast (10) including one by **Carol Welch** (Cherokee), and three (3) from Southwest artisans, eleven (11) from Northeast/Great Lakes basket weavers, and one (1) from the Northwest Coast, USA; two (2) Gullah (eastern US) **baskets**, including one by **Jennifaye Singleton**; two (2) Huichol (Mexico) mosaic **beadworks**
Gift of **Ron and Lynne Wetherell** (Green Cove Springs, FL),
to the Museum's Baker-Beasley-Wetherell Collection

Group of twelve (12) modern, native American **baskets**, including one by **Sally Locust** (Cherokee) and one by **Emma Taylor** (Cherokee), two (2) from the Tohono O'odham (Papago) plus one each from Ho-chunk (Winnebago), Makah, Nootka, Paiute, Penobscot, Seneca, Siletz, and Choctaw artisans; five (5) **gourd rattles** (Hopi) including one by **Lauren Honyouti** and one "salt-shaker" **rattle** (Navajo); **dance sash** (Hopi); **books** and specialty publications (61) for the Research and Public Reference libraries
Gift of **June Beasley** (Flagstaff, AZ) *to the Museum's Baker-Beasley-Wetherell Collection*

Group of thirteen (13) **baskets** from Ho Chunk (Winnebago), Micmac, Seri, Yaqui, Tarahumara, Tohono O'odham (Papago), Havasupai, Choctaw, and upper Amazonian native American groups; two **dance wands** (Navajo) and four (4) **weavings** (Navajo); book
Gift of **Bob Baker** (Tucson, AZ) *to the Museum's Baker-Beasley-Wetherell Collection*

Group of ten (10) dyed, applique and embroidered raffia palm **Kuba Cloths** (Kuba peoples, Democratic Republic of the Congo, 20th century)
Gift of **Dr. David Rilling** (Sellersville, PA)

Cast bronze **dagger** (Neo-Babylonian-type, ca. 500 BC); ground stone **macehead**, ceramic stirrup-spouted jar and two (2) ceramic oil **juglets** (trade goods to Canaanite-Israel, ca. 1500 - 1200 BC); cast bronze **strigil** (body scraper, Roman-era Israel, 1st- 4th centuries). All purchased in Israel in early 1980's. Two (2) baked clay effigy **figures** (west Saharan Africa) purchased in Cote d'Ivoire in 1980's.
Gift of **MAW** (Claremont, CA)

Group of Precolumbian materials from central Andes, including twenty-two (22) cotton and camelid wool **cloths**; seventeen (17) alloyed metal **ornaments**; eighteen (18) ceramic, stone, and shell **ornaments and tools**; nine (9) ceramic **vessels**; two (2) **baskets**. Various dates, from ca. 1500 BC - AD 1400; **headband** and **dance belt** (Amazon region of Peru, early 20th century)
Gift of **Dr. Daniel Rifkin** (New York City, NY)



Ceramic Headrest, ca. A.D. 400-1000
Marajo Island, Brazil
Gift of **Dr. Daniel Rifkin**



Ceramic Pitcher, ca. 1730-1550 BC
Canaanite (Israel)
Gift of **MAW**



Owl Effigy, 2015
Elias Pena
Mata Ortiz, Chihuahua, Mexico
Museum Purchase



Coiled Basket, ca. A.D. 100-500
South Coast Peru
Gift of **Dr. Daniel Rifkin**

RECENT ACQUISITIONS (continued)

Gifts to the Collections (October - December, 2015)

Group of 116 prehistoric ceramic **sherds**, collected from throughout North Texas and subsequently sold as abandoned goods with other personal property; to the Museum Study collections

Gift of **Cheryl Turner** (Simms, TX)

Pieced, natural and dyed **deerskin rug**, mounted to historic fabric (Lake Superior Ojibway, early 20th century; purchased at auction, 1957)

Gift of **Stacy Jack** (Ft. Frances, ONT, Canada)

Pair of long-necked **vases**, hand-finished and carved, molded composition “cinnabar lacquer” (Chinese, late 19th/early 20th century)

Gift of **Wally Mason** (Cody, WY)

10 groups of items, collected 1970 - 1975, including four (4) clam-shell bead **necklaces** and bamboo **strainer for yucca flour production**, (Kamayura peoples, Mato Grosso, Brazil), four (4) **seed-bead belts/necklaces** and two (2) pairs of **earrings** (Urubu Kaapor peoples, Para, Brazil), four (4) copper **ornaments** (Moche Culture, Peru, ca. AD 500), tubular **lime container** of wood (Chavin Culture, Peru, ca. 500 BC), woven **sash ornament** (Nazca Culture, Peru, ca. AD 500), six (6) white metal “**milagros**” (Lima, Peru), arm and ankle **dance ornaments**; five (5) **books** on ethnographic art

Gift of **Michael A. Bernstein** (Tucson, AZ)

Historic **postcards** (7)

Gift of **Vickie and Scott Smith** (Idabel, OK)

Mortars (2) by **Tadashi Hirakawa** (b. Japan); Bizen-style stoneware, created and fired in experimental *tsuchigama* earth kiln built in Horatio, AR

Gift of the Artist

Collection of projectile **points** and associated **debitage** from sites in Pushmataha County, OK; mammoth **tusk**, originally recovered in Grady County, Oklahoma

Gift/Transfer from the **Oklahoma Archeological Survey**

Museum Purchases

Jewelry **box** of lacquered wood, enamel-decorated with scenes of travel; **bowl** decorated with images of *Seven Gods of Good Fortune* and other deities, and **dish** with military parade scene, both of Satsuma-style glaze and enamel painting; brass **tray** and covered **box** with enamel painted *cloud dragon* scenes; articulated bronze **crab effigy**.

(all Japanese, ca. 1880 - 1925)

Nathaniel and Lana Grey Collections Fund

Other Donors to the Collections in 2015

June **Beasley** to the Museum’s *Baker-Beasley-Wetherell Collection*, Michelle and Art **Black**, Jeanette and Greg **Bohanan**, Lila and Terry **Cantwell**, Ginny and Peter **Carl**— *In Memory of J. Marshall Gettys*, Steve **Domjanovich**— (1) *In Memory of J. Marshall Gettys* and (2) *In Memory of Mary H. Herron*, Ron **Dunnett**— *In Memory of Emile H. Mathis*, Christina and Billy **Eastep**, Wayne **Edgar** Family (Ardmore, OK), Ethel **Fuller** and (the late) Beulah **Turgeon**, Sally **Gettys**, Sally **Gettys and Family**— *In Memory of J. Marshall Gettys*, Sarah Jane and Tom **Harding**, Janet **Herron** and Gamaliel **Leyva**, Terrance **King**, Luisa and Dr. Ernesto **Lira**, Doris N. **Linduff Ficke Blakley**, Pat and John **Malin**, Sherron **Mitchell**, Henry **Moy**, Jeffrey **Moy**, Dr. Robert and Marianne **Pickering**, Joyce **Pipps**, Dr. David and Karina **Rilling**, (Patagonia, AZ), Paul A. **Shepard**, Vickie and Scott **Smith**, Dr. Alvin O. **Turner**, Katie and Daniel L. **Vick**, Dr. Richard **Weiss**; **Chickasaw Cultural Center** (Sulphur, OK), **Herron Industries**, **MAW**



Bowl Depicting Seven Gods of Good Fortune, ca. 1880-1925
Japan

Museum Purchase,
Nathaniel and Lana Grey Collections Fund



Basketry Purse, ca. 2000
Penobscot (Northeast)

Gift of June Beasley to the Museum’s
Baker, Beasley, Wetherell Collection



Basketry Tray, ca. 1990
Amazonia

Gift of Bob Baker to the Museum’s
Baker-Beasley-Wetherell Collection



Ceramic Bowl, ca. 200-100 BC
Paracas, South Coast Peru
Gift of Dr. Daniel Rifkin

The Tsuchigama Project

Tsuchigama or “dirt kiln” is recognized by scholars as Japan's earliest high-fire kiln type. It fell out of use over 700 years ago when the anagama kiln became popular, and has not been used since. Japanese sculptor **Tadashi Hirakawa** and a team of archaeologists have uncovered and excavated sites of ancient tsuchigamas and have been collaborating for several years to recreate the ancient kiln type. The team has successfully made and used two tsuchigamas in Bizen, Japan and is working hard to revive the techniques and styles associated with the tsuchigama, such as Bizen-ware, as a contemporary art practice.

This summer, Tadashi Hirakawa travelled to the US and teamed up with **Chris Powell** (Associate Professor of Art, Texas Christian University) to create a tsuchigama in Sevier County, Arkansas. With the help of two students from Japan, **Yukiko Akai** and **Tomoko Sakamoto**, and two TCU students, **Sydney Williams** and **Courtney Hamilton**, the tsuchigama was built into a hillside in southwest Arkansas.



Mortars (2), 2015
by Tadashi Hirakawa (b. Japan)
Gift of the Artist

PEOPLE & PROGRAMS

Fall ArtsFest is an annual celebration of antiques and art. This year's event included eleven artist/vendors and pottery-making demonstrations by **Chase Earles** (Oklahoma Caddo) and brothers **Arturo** and **Efren Quezada** (Mata Ortiz, Mexico). Also included was the biennial appraisal opportunity *What Is It? and What Is It Worth?* with **Dane Pollei** of the Mabee-Gerrer Museum and **Dr. Robert Pickering** of the Gilcrease Museum, **Mike Thomas** of Arkansas, and **Ed Oerichbauer** of Minnesota. Additionally, **Carolynn Neal**, recently retired from the Oklahoma Archeological Survey provided artifact identifications. State Archeologist **Dr. Robert Brooks** joined the day's activities by presenting *Mammoths to Mounds*, sponsored by **Preservation Oklahoma**.



Arturo and Efren Quezada

IMSI board member **Dr. Robert Brooks** retired at the end of 2015 from his positions as *Oklahoma State Archeologist* and *Director of the Oklahoma Archeological Survey*. Head of Programs **Christina Eastep** and Head of Communications **Jeanette Bohanan** attended the *2015 Oklahoma State Arts Conference* in Tulsa, OK.



Chase Earles

Jeanette also attended the *Sarkeys Foundation Southwest Leadership Forum* in Norman, with office manager **Vickie Smith**. Vickie continues as president of the **Idabel Regional Arts Council**.

Museum director **Henry Moy** spoke to the **Durant Rotary Club** about upcoming renovations. He continues as executive secretary of **Herron Foundation, Inc.**, vice president and treasurer for the **McCurtain Community Fund**, treasurer for the **McCurtain County Gem and Mineral Club** and the **Idabel Regional Arts Council**, and an active member of the **Rotary Club of Idabel**.



Nicolette Meister and Sammi Kinard

Sammi Kinard, a summer intern at the Museum, continues her interests in Mata Ortiz pottery. The anthropology and museum studies student from **Beloit College** in Wisconsin was initially inspired by a class project. Her experience was broadened at the Museum of the Red River, joining a trip to the namesake village in Mexico's Chihuahua State. There she assisted with acquiring ceramics for the collections of Beloit College's **Logan Museum of Anthropology**. Her work is highlighted in *Collecting Today*, an article for Beloit's Fall/Winter 2015 alumni magazine, written by Logan Museum curator **Nicolette B. Meister**. Ms. Meister was also the Museum's guest speaker at this year's Patrons Dinner.

GIFTS and SUPPORT

(2015; **names in bold** are of donors whose gifts were received in the last quarter)

Gifts to the General and Programs Fund

*Gift In Celebration of the Wedding of Chill and Lolly, **Lavetta Angelley**– In Memory of Quintus H. Herron, James Bailey, Dr. A. Gleny Beach, Mr. and Mrs. James H. Childers– In Memory of Cephis Hall, Judy Christensen and John McDonnell, Leora and Mehdy Douraghy, Don and Peggy Dugan, Dr. Walter and Melinda Frey, **Nita M. Fuller**, Sally A. Gettys– In Memory of Mary and Quintus Herron, Jamie and Brian Girard, **Delcyne Grant**– In Honor of Joyce and Cephis Hall, **Nadya Green and Kevin Green**, Janet Herron and Gamaliel Leyva, Jimm and Jackie Jacobs– In Memory of Betty Bradshaw, William T. and Billie Kelley– In Memory of Quintus Herron, **Dr. Bruce King, Terrance King, Henry Moy, Jack Moy,Carolynn Neal**, Lloyd W. Page, Drethia Parsons, **State Rep. R.C. Pruett**, Patti Pugh, **John and Ida Ramsey, Robin and Bob Terry, Lewis and Tina Foshee-Thomas, Beulah Turgeon (dec.), Bob and Jeanie West***

First Baptist Church of Wake Village (TX), **Donald A. Herron Trust**, Herron Foundation, Inc., **Quintus H. Herron Trust, The Kerr Foundation, McCurtain County Bar Association**, Tulsa Community Foundation

Gifts to J. Marshall Gettys Memorial Fund

Arthur Black, Mary Ann Blochowiak, Jim and Anita Bourke, Pam and Bob Brooks, James and Candace Bowen, Maxwell and Betty Bowen, Mr. and Mrs. Chester R. Cowen, Rose Fosha, John D. and Melvena Heisch, Terry and June Helvey, Lydia Kachadoorian, Steve and Susan Kline, Jewell J. Lynch, Jack and Pam and Hannah McCarty, Rebecca E. Meyer, Staff of the Museum of the Red River, Jerry and Mary Owen, Vickie Smith, Ron and Doris Smithee, Jess and Anita Thiel, Dr. A.O. Turner, Daniel L. Vick, Sallie Webb, OKC Indian Art Club, Oklahoma Native Basket Weavers Association

Gifts to the Libraries (including Research, Learning Center, and Public Reference)

Bob Baker, June Beasley (2), Michael Bernstein, Janet Herron, **Sally Gettys**, Henry Moy, Dr. David Rilling, **Mike and Anita Stevenson (2)**

Gifts in Kind

Angelica Bohanan, Naomi Bohanan, Rabecca Bohanan, Kaitlynn Bray, Kale Bray, **Dr. Robert “Bob” Brooks**, Dr. Kenneth Carpenter, Zoe Cox, Victoria Eastep, Sally Gettys, Linda Kaczmarcek, Emily Martin, Matthew Mussett, Meric Mussett, **Carolynn Neal, Edgar S. Oerichbauer**, Rick Oestricher, Doris W. Perkins, **Dane Pollei, Dr. Robert Pickering**, Betty Ramsey, Grace Robbins, Lauren Robbins, Ezekiel Shomo, **Scott Smith, Bob Terry, Mike Thomas**, Sallie Webb, Sarah Weeks, Sherri Wooldridge

AJ's Steak & Pasta, Choctaw Nation of Oklahoma, Coca-Cola of Idabel, Heritage Museum of Asian Art, Herron Foundation, Inc., International Paper, Mabee-Gerrer Museum of Art, Nerwin & Martin Fine Arts Services, Walmart Store 117– Broken Bow

Museum Building Fund

Jeanette and Greg Bohanan, Janet Herron, Rudy and Chris Michalek, Doris W. Perkins, Betty R. Ramsey, Sallie Webb, Carolyn D. and Eddie White

Girls Gone Wine, Michael S. McElroy Insurance

2015-16 Corporate Sponsors

(Business donors whose contributions support the Museum's free admission policy)
AJ's Steak and Pasta, All Smiles Dental, Bob Terry Insurance and Financial Services, Bear State Bank, Bob Norris, Colonial Lodge Independent Living, Complete Care Medical Supply, D & M Chipping, Don Shaw– Attorney, Edward Jones, Inc. (Idabel), Fenix Industries, First State Bank–Valliant, G.I Surplus and Pawn, Hill Nursing Home, Hometown Rental, The Idabel National Bank, Idabel Veterinary Clinic, International Paper, McCurtain Co. Bar Association, Michael S. McElroy Insurance, Rustin Concrete, SETCO, Tom Ellis– Attorney at Law, Waterhouse of Idabel ww



Kuba Cloth, mid 20th century
Democratic Republic of the Congo
Gift of Dr. David and Karina Rilling

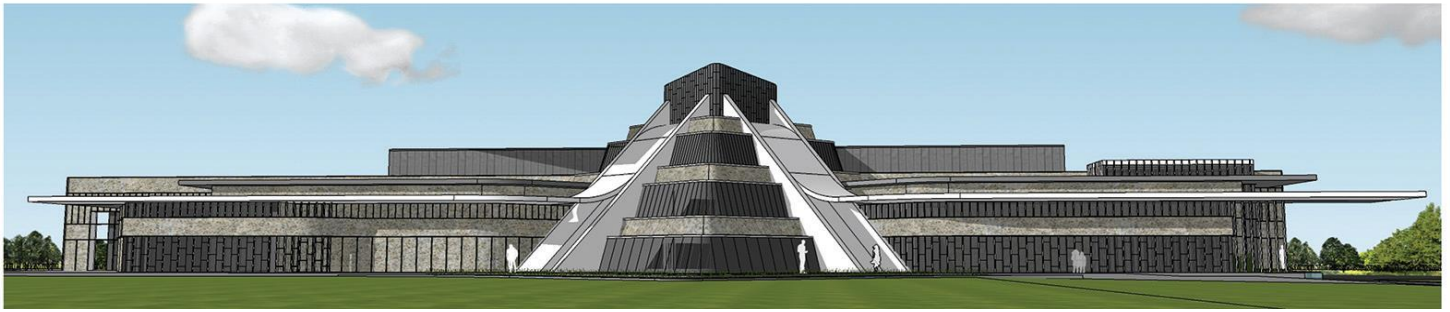

The **Museum of the Red River** is the largest exhibiting facility within a 150 mile radius, providing both learning opportunities and aesthetic experiences to its audiences. Through its exhibits and public educational programs, it offers unprecedented access to some of the finest cultural artifacts in the nation, representing native American groups and others from around the world. Its three *Student, Public Reference, and Research* libraries offer over 5000 volumes and printed materials illustrating cultural history. The *Holland and Sallie Webb Family Learning Center* provides hands-on, interactive experiences for students of all ages.

Off-site displays are installed at four regional libraries (Idabel, Broken Bow, Valliant, and Hugo), Southeastern Oklahoma State University's McCurtain County Campus, the Oklahoma Forest Heritage Center and the Kiamichi Family Medical Ctr.

The Museum's budget is supported by investment income, earned income, and the ongoing support of individuals, families, corporations and foundations. It neither solicits nor accepts government funding. Additionally, it works in cooperation with other arts and cultural agencies to provide activities and events to the public.

Idabel Museum Society



812 E. Lincoln Road
Idabel, OK 74745
(580) 286-3616

NON-PROFIT ORGANIZATION
U.S. POSTAGE
PAID
PERMIT #45
IDABEL, OK 74745

RETURN SERVICE REQUESTED



Beaded Elephant, ca. 2000
Huichol (Mexico)

Gift of **Ron Wetherell** to the Museum's Baker-Beasley-Wetherell Collection



www.museumoftheredriver.org



Museum Hours:
TUE-SAT 10 AM-5 PM, SUN 1 - 5 PM
Closed Mondays and national holidays
FREE ADMISSION